

EIFS/ETICS

FACADE INSULATION
SYSTEM

EXTERIOR
INSULATION &
FINISHING SYSTEM

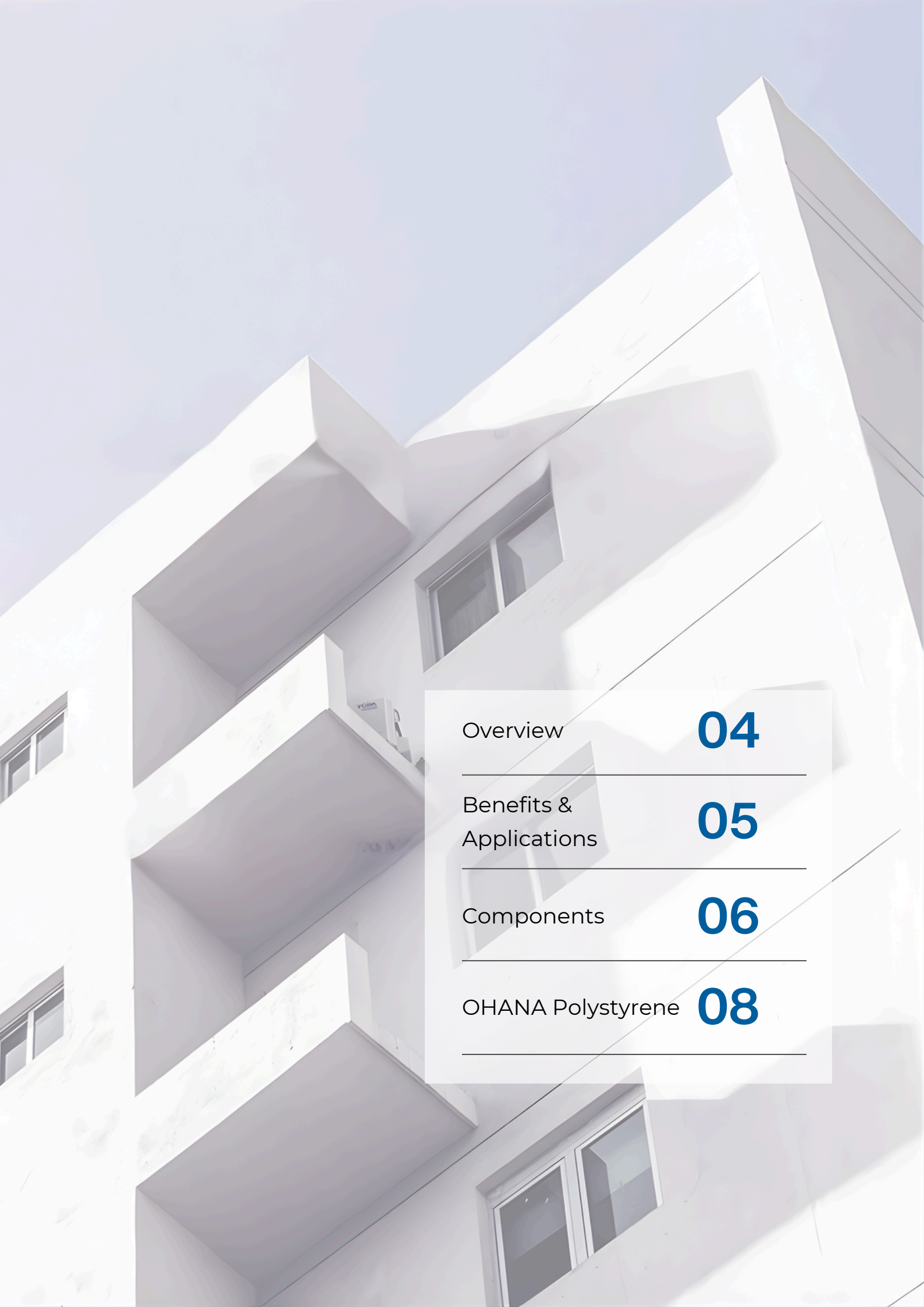



Overview

04

Benefits &
Applications

05

Components

06

OHANA Polystyrene

08

Exterior Insulation and Finishing System (EIFS / ETICS) **Excellent Insulation. Superior Elegance.**

EIFS/ETICS is an advanced multi-layered external wall insulation system designed to significantly enhance a building's thermal efficiency, reduce energy consumption, and provide a durable, crack-resistant and aesthetically flexible façade finish. Widely trusted across Europe, GCC and global construction markets, EIFS delivers superior insulation performance while protecting building envelopes against harsh weather conditions, moisture, and structural stresses.

A Strategic Alliance for **Building Envelope Excellence**



OHANA is the UAE's only trusted manufacturer offering the full spectrum of insulation: OHANAFOAM (EPS), GRAYFOAM (Gray EPS), and EXPOFOAM (XPS). With a 300,000 sq.ft state of the art facility, high volume capacity, and strong regional distribution, our products are engineered to perform in the harsh GCC environment.



THRAKON is a European construction materials leader with over 60 years of expertise, 1,700+ product codes, and six advanced production plants in Greece. Operating across more than 40 countries, the company delivers ISO and CE certified systems and is widely recognized for its strong specialization in ETICS through the CLIMAPLUS façade insulation system.



Exclusive Regional Partners for UAE & OMAN

EIFS/ETICS- Facade Insulation System

Benefits for Hot Climates

Why EIFS/ETICS is Essential for Modern Middle East Construction

The Middle East experiences some of the highest solar loads globally—impacting energy consumption, structural durability, and indoor comfort.

EIFS/ETICS offers unmatched façade insulation performance.



Lower Cooling
Energy Consumption



Stable Indoor
Temperature



Strong Reduction-
Carbon Emissions



Complete Elimination
of Thermal Bridges



Superior External
Façade Protection



Enhances Acoustic
& Fire Performance

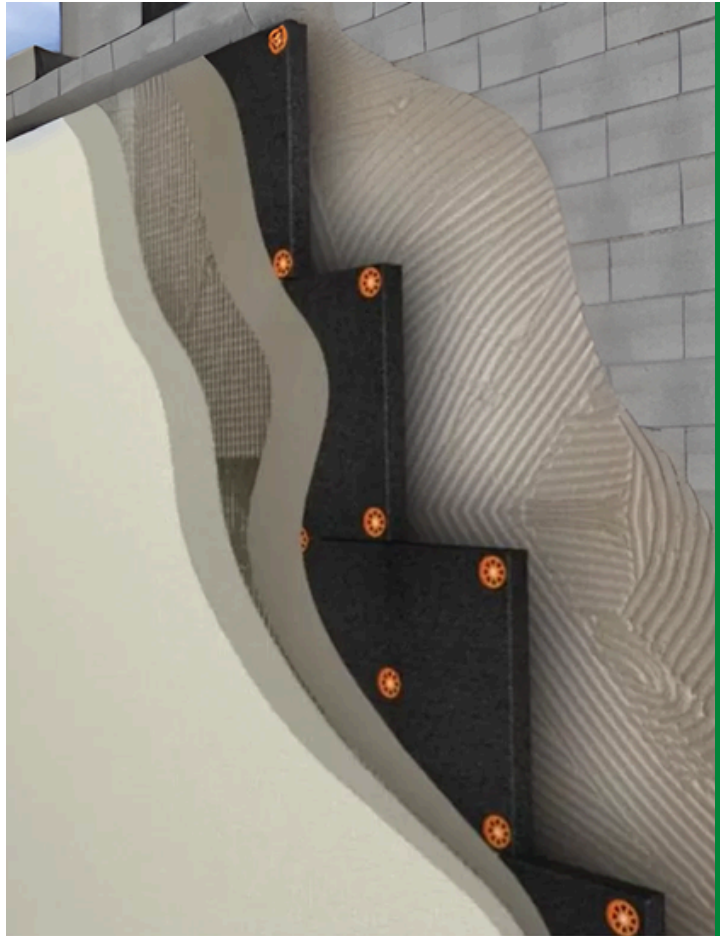

High-Rise Residential &
Commercial Buildings



Villas &
Townhouses



Hotels, Resorts &
Hospitality Buildings



Schools, Universities
& Public Buildings



Retail, Shopping Malls &
Commercial Complexes



Mosques & Cultural
Buildings

EIFS/ETICS

Complete System

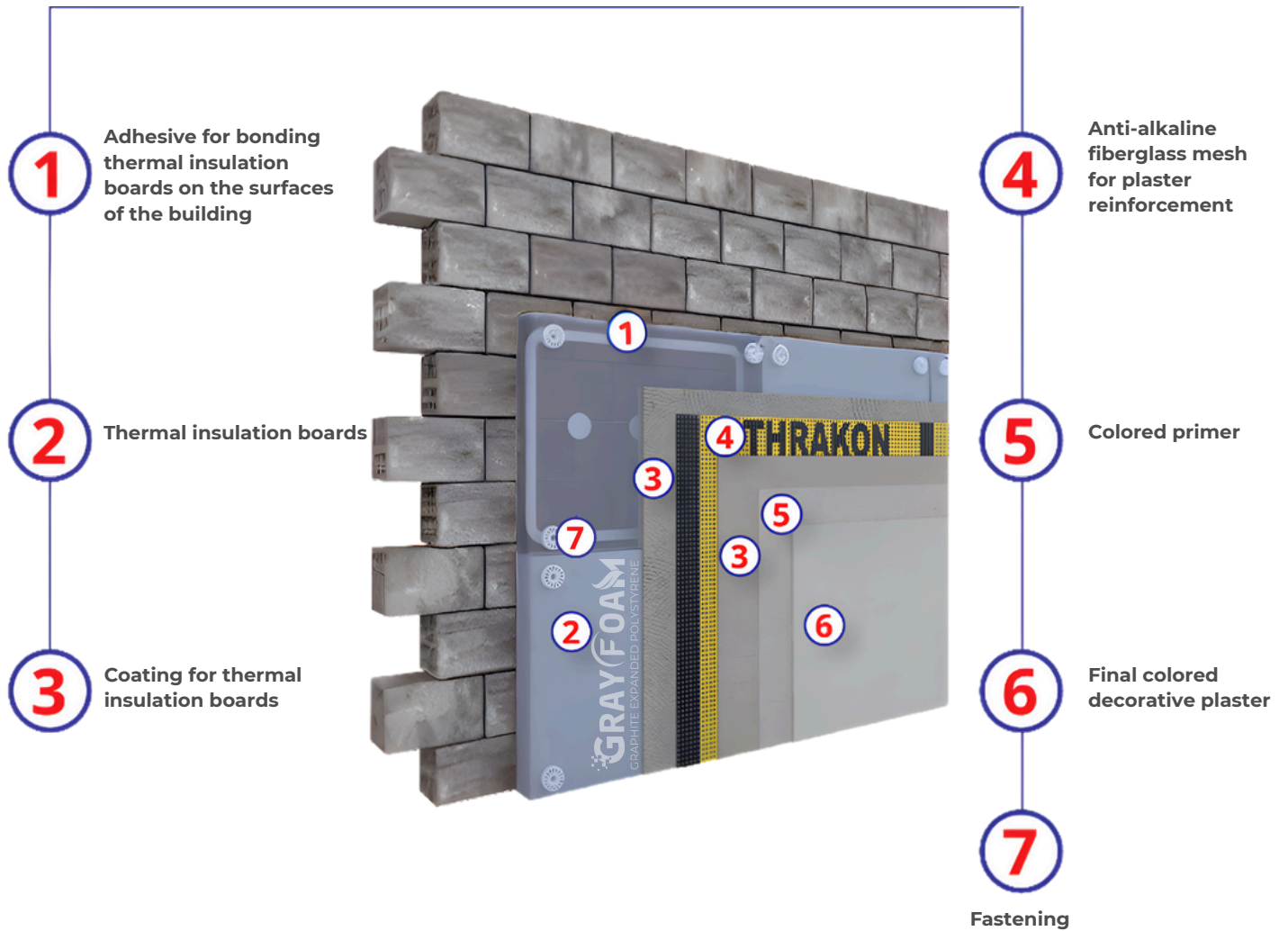

Adhesives for Insulation Boards / Basic Coat Plaster



PRO THC 404

Fiber reinforced, cement based adhesive - plaster

Fiber reinforced, polymer modified, cement based mortar.



Code	Pkg	Shade
P11834325	25 kg	Grey
P11834225	25 kg	White

-  Suitable for bonding and plastering thermal insulation boards on ETICS(EIFS)
-  Exterior use  3.5 - 4.0 kg/m²
-  60 items

Quick Installation Guide

- Surface must be clean, stable, flat.
- Mix 25kg bag with 6–6.5 L water, rest 5 min, usable for 4 hours.
- Apply adhesive on flat surfaces with notched trowel, or perimeter + spots on uneven walls. Open time ~15 min.
- After boards are fixed and anchors applied, spread 2–4mm layer, embed mesh with 10–15cm overlap, cover fully with mortar.

Impregnating Coating







CLIMA PRIMER GLX 494

Acrylic primer - Transparent

Acrylic based primer with high penetration. Colored according to the shade chosen for final coating (organic plaster).



Code	Pkg	
P21470005	White 5 kg	
P 21800025	White 25 kg	
C/C	Colored	Group A 5 kg
C/C		Group A 25 kg
C/C		Group B 5 kg
C/C		Group B 25 kg
C/C		Group C 5 kg
C/C		Group C 25 kg

-  Suitable for the preparation of the substrate prior to the application of acrylic based organic plasters and paints.
-  Exterior & Interior use  ~0.20 - 0.25 kg/m² per layer
-  36 items (25 kg) 60 items (5 kg)  White and in thousands shades

Dilution: 15% - 20% with water *

Quick Installation Guide

- Dilute with 25% clean water before use
- Apply 1 coat (2 coats if high temperature or highly absorbent surface)
- Apply by roller or spray, avoid rain and frost
- Rain resistant after 24 hours, apply paint only after full drying
- Substrate & ambient temperature must be above +5°C
- Consumption: 0.20–0.25 kg/m²
- Shelf life: 1 year, stored sealed above 0°C
- Safety: protect eyes/skin, rinse with water if contact, wear PPE



Innovative insulation.
 “ Timeless aesthetics.
 Elevate your façade.

OHANA Polystyrene

For EIFS Insulation & Decorative Architecture

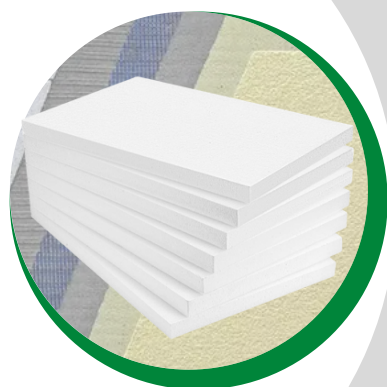

OHANA EPS

OHANA EPS is a lightweight, cost-effective insulation board used in EIFS for its stable thermal performance, easy workability, and smooth finish.

BRAND:



ASTM C 578: 2023	VALUES
Density Range (Kg/m ³)	12-60
Compressive Resistance (kPa)	35-414
Thermal Resistance R-Value (K-m ² /W)	0.53-0.73
Thermal Conductivity K-Value (Max, W/m.K @ 35 °C and 60 % RH)	0.0347-0.0482
Flexural Strength (Min, kPa)	70-517
Water Vapor Permeance (of 25.4 mm thickness, max, perm)	2.5-5.0
Water Absorption (Total immersion, max, Volume %)	2.0-4.0
Dimensional Stability (Change in dimensional, max %)	2.0
Oxygen Index (Min, volume %)	24

EPS Decorative Architecture

OHANA XPS

OHANA XPS is a high-strength, closed-cell insulation board that provides superior moisture resistance and durability for EIFS, especially in high-impact or humid areas.

BRAND: **EXPOFOAM**
EXTRUDED POLYSTYRENE BY OHANA

ASTM C 578: 2023	VALUES
Density Range (Kg/m ³)	29-50
Compressive Resistance (kPa)	276-690
Thermal Resistance R-Value (K-m ² /W)	0.84
Thermal Conductivity K-Value (Max, W/m.K @ 35 °C and 60 % RH)	0.0303
Flexural Strength (Min, kPa)	414-690
Water Vapor Permeance (of 25.4 mm thickness, max, perm)	1.1
Water Absorption (Total immersion, max, Volume %)	0.30
Dimensional Stability (Change in dimensional, max %)	2.0
Oxygen Index (Min, volume %)	24

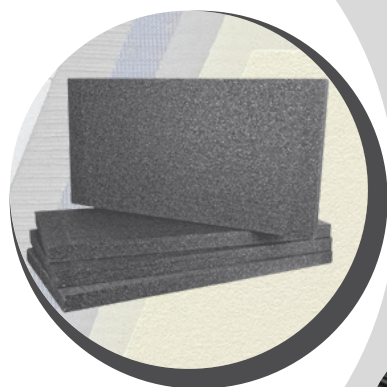
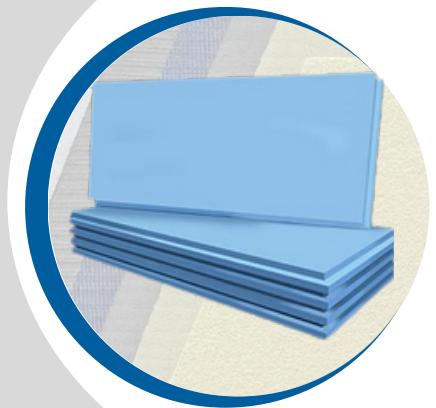

OHANA GRAY EPS

OHANA Gray EPS is a graphite-enhanced insulation board offering significantly higher thermal efficiency than regular EPS, enabling thinner, energy-efficient EIFS systems.

BRAND:



ASTM C 578: 2023	VALUES
Density Range (Kg/m ³)	15-22
Compressive Resistance (kPa)	69-90
Thermal Conductivity K-Value (Max, W/m.K @ 35 °C and 60 % RH)	0.0295
Flexural Strength (Min, kPa)	173-208
Water Vapor Permeance (of 25.4 mm thickness, max, perm)	3.5-5.0
Water Absorption (Total immersion, max, Volume %)	2.0-4.0
Dimensional Stability (Change in dimensional, max %)	2.0
Oxygen Index (Min, volume %)	24

Gray EPS Decorative Architecture



Engineering Polystyrene Solutions



Top Coat

- ACRYLIC BASED ORGANIC PLASTERS



CLIMA PLASTER DEC 428

Decorative acrylic plaster

Acrylic based render with high elasticity and excellent adhesion, offering tinted end surfaces in different types (RILLEN or SCRATCH), without the need to paint.



Suitable for application as a final coat render for EIFS/ETICS and for indoor or outdoor masonries.



Exterior & Interior use



It can be colored in more than 600 shades



36 items



RILLEN

2.0 mm: 2.7 kg/m²

SCRATCH 1.0 mm:

1.8 kg/m² 1.2 mm:

2.0 kg/m² 1.5 mm:

2.5 kg/m² 2.0 mm:

3.3 kg/m²

FINE

2.0 kg/m²



Code	Pkg	
C/C	White 25 kg	
C/C	Colored	Group A 25 kg
C/C		Group B 25 kg
C/C		Group C 25 kg

Quick Installation Guide

- Clean the surface and remove dust, oils, and loose particles.
- Repair cracks and uneven areas.
- Apply GLX 494 PRIM primer.
- Mix DEC 428 POLYPLAST with an electric stirrer and apply with a stainless steel spatula.
- Finish with a plastic spatula and clean tools immediately with water.

Reinforcement



CLIMAPLUS PROFESSIONAL (160 g/m²)

Anti-alkaline fibreglass mesh, produced under ETAG 004.



Suitable for reinforcing the basic layer of the exterior thermal insulation system CLIMAPLUS.



Exterior use



1,1 m/m²



35 rolls



1m × 50m

Grid size: 4 x 4 mm



Code	m ² / Palette
T 10320120	1750

Fastening



PLASTIC ANCHORS FOR BRICKS

CLIMAPLUS - Plastic anchor for fastening insulation boards on bricks. Applied by nailing. European Technical Approval (ETA).



200 Items



Code	Dimensions
T10121070	60mm × 10mm × 70mm
T10121090	60mm × 10mm × 90mm
T10121120	60mm × 10mm × 120mm
T10121140	60mm × 10mm × 140mm
T10121160	60mm × 10mm × 160mm
T10121180	60mm × 10mm × 180mm
T10121200	60mm × 10mm × 200mm

**We build together
for a better living**





info@ohanauae.com

800-OHANA (64262)

www.ohanauae.com



Engineering Polystyrene Solutions

JOIN COMMUNITY



UPDATES • INSIGHTS